

STRADA GOSPODARIEI, nr. 6, SECTOR 3, BUCURESTI



P.U.D.

PLAN URBANISTIC DE DETALIU

PROPUNERI SI REGLEMENTARI

REGLEMENTARI URBANISTICE

S teren= 1221mp (din masuratori cadastrale)
EXISTENT

- S construita la sol C1 = 238 mp
- S construita la sol C2 = 50 mp
- S construita la sol C1+C2 = 288 mp
- S desfasurata C1 = 348 mp
- S desfasurata C1+C2 = 398 mp
- POT existent = 23%
- CUT existent = 0.32

PROBUS

- S construita la sol C3 = 127 mp
- S desfasurata C3 = 254 mp
- REGIM DE INALTIME propus - P+1E

EXISTENT+PROBUS

- S construita la sol C1+C2+C3 = 415 mp
- S desfasurata C1+C2+C3 = 652 mp
- POT maxim = 60% - POT propus = 33.9%
- CUT maxim = 1.2 - CUT propus = 0.53
- 4 locuri de parcare in incinta

LEGENDA:

- Acces
- Circulatii carosabile
- Circulatii pietonale
- P+1E Imobil locuinta
- L1e Subzona locuinte individuale pe loturi subdimensionate
- Lot ce a generat PUD
- Limita zonei studiate

INVENTAR DE COORDONATE
 Sistem de proiectie - Stereo 70

Pct.	X	Y
1	323 961.261	592 731.925
2	323 947.350	592 742.730
3	323 943.880	592 746.360
4	323 936.673	592 729.816
5	323 933.990	592 723.340
6	323 932.710	592 718.410
7	323 933.300	592 718.150
8	323 928.610	592 696.604
9	323 918.963	592 671.405
10	323 928.412	592 667.287
11	323 932.297	592 675.844
12	323 938.253	592 688.610
13	323 939.191	592 688.410
14	323 947.630	592 703.920
15	323 948.820	592 706.400
16	323 952.750	592 715.314
17	323 953.979	592 716.750
18	323 958.498	592 725.671
19	323 960.055	592 730.124

Suprafata totala masurata = 1221,00 mp
 Suprafata totala din acte = 1380,00 mp

PROIECTANT: **ARH. ROSCAN CATALIN**
 BIROU INDIVIDUAL DE ARHITECTURA ROSCAN CATALIN
 Adresa: B-dul Mamaia, Nr. 51, Sector 3, Bucuresti
 TEL. 0723 198 498

SEMNTURA:

SCARA: 1:500
 DATA: 03.2016

SPECIFICATIE	NUME SI PRENUME	SEMNTATURA
VERIFICAT	ARH. ROSCAN CATALIN	
PROIECTAT	ARH. ROSCAN CATALIN	
DESENAT	ARH. ROSCAN CATALIN	

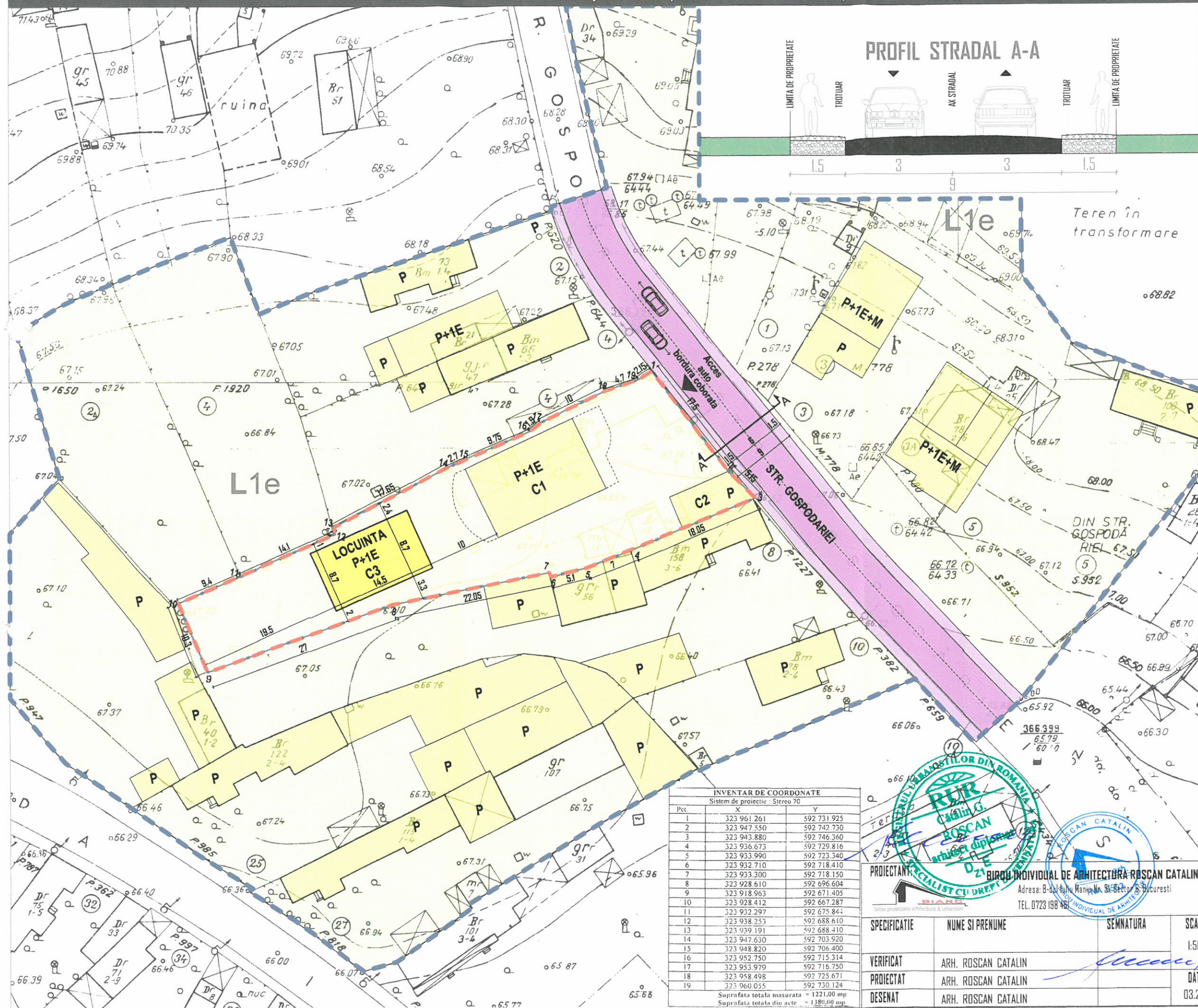

INVENTAR DE COORDONATE	
Sistem de proiectie : Stereo 70	
X	Y
323 961.261	592 731.925
323 947.550	592 742.730
323 943.880	592 746.360
323 936.673	592 729.816
323 933.990	592 723.340
323 932.710	592 718.410
323 933.300	592 718.150
323 928.610	592 696.604
323 918.963	592 671.405
323 928.412	592 667.287
323 932.297	592 675.844
323 938.253	592 688.610
323 939.191	592 688.410
323 947.630	592 703.920
323 948.820	592 706.400
323 952.750	592 715.314
323 953.979	592 716.750
323 958.498	592 725.671
323 960.055	592 730.124

Suprafata totala masurata = 1221,00 mp
Suprafata totala din acte = 1380,00 mp

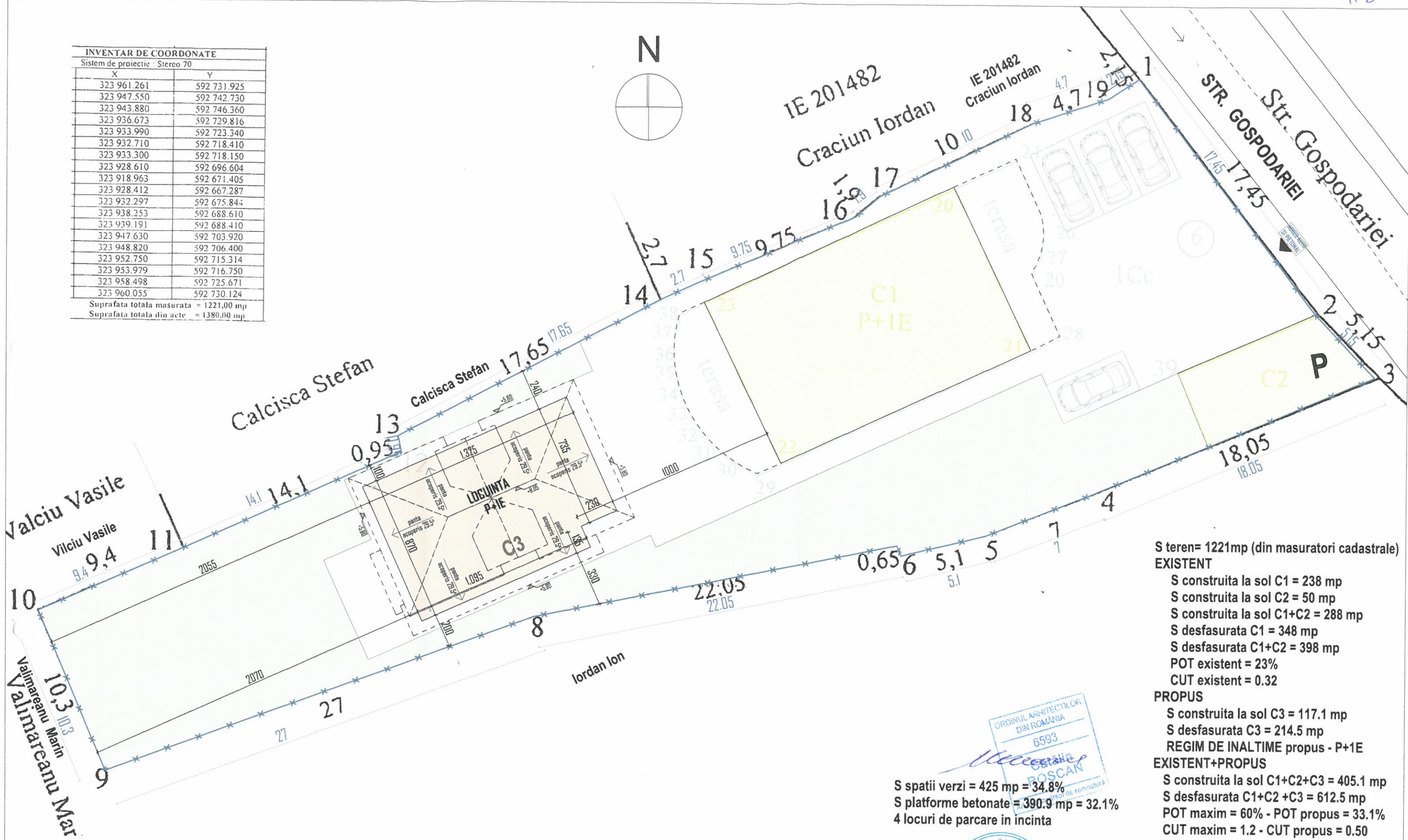
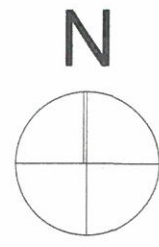

S teren= 1221mp (din masuratori cadastrale) EXISTENT

- S construita la sol C1 = 238 mp
- S construita la sol C2 = 50 mp
- S construita la sol C1+C2 = 288 mp
- S desfasurata C1 = 348 mp
- S desfasurata C1+C2 = 398 mp
- POT existent = 23%
- CUT existent = 0.32

PROPOS

- S construita la sol C3 = 117.1 mp
- S desfasurata C3 = 214.5 mp
- REGIM DE INALTIME propus - P+1E

EXISTENT+PROPOS

- S construita la sol C1+C2+C3 = 405.1 mp
- S desfasurata C1+C2+C3 = 612.5 mp
- POT maxim = 60% - POT propus = 33.1%
- CUT maxim = 1.2 - CUT propus = 0.50

S spatii verzi = 425 mp = 34.8%
S platforme betonate = 390.9 mp = 32.1%
4 locuri de parcare in incinta



PROIECTANT:  BIROU INDIVIDUAL DE ARHITECTURA ROSCAN CATALIN Adresa: B-dul Iuliu Maniu, Nr. 51, Sector 6, Bucuresti TEL: 0722 196 481 TEL: 0722 196 481		BENEFICIAR: BANEA CONSTANTIN	PROIECT NR. 3/3/16
SPECIFICATIE	NUME SI PRENUME	SEMNATURA	SCARA: 1:200
VERIFICAT	ARH. ROSCAN CATALIN	DATA: 04.2016	TITLU PROIECT: Construire locuinta individuala cu regim de inaltime P+1E ADRESA : Str. Gospodariei, nr.6, Sec. 3, Bucuresti
PROIECTAT	ARH. ROSCAN CATALIN	DATA: 04.2016	FAZA D.T.A.C.
DESENAT	ARH. ROSCAN CATALIN	DATA: 04.2016	PLANSĂ NR. A 01
TITLU PLANSA: PLAN DE SITUATIE			PLAN DE SITUATIE