

# ALEEA LUNCA CORBULUI, nr. 2, LOTUL 2, SECTOR 3, BUCURESTI



## P.U.D.

### PLAN URBANISTIC DE DETALIU

#### PROPOUNERI SI REGLEMTARI

Bilant teritorial pe parcela studziata			
	Existent	Prevederi PUG	Propus
Suprafata teren (acte/masuratori)	2938mp	2938mp	2938mp
Suprafata construita ( Sc )			392mp
Suprafata desfasurata ( Sdc )			392mp
P.O.T.		15%	13.3%
C.U.T		0.2	0.13
R.H.max		P+2niveluri	parter
H.max (m)		9.0 m	7.0 m
Spatii verzi (m%)			1.656 mp 56.4%
Nr. unitati locative			
Nr. locuri de parcare			3
Suprafata de teren afectata de supralargire strada			77.5 mp

#### LEGENDA:

- Acces
- Circulatii carosabile
- Circulatii pietonale
- P Imobil existent
- P Imobil hala propus
- V1a Subzona parcuri, gradini si scuaruri publice orasenesti si fasii plantate publice
- Lot ce a generat PUG
- Limita zonei studiate

Parcel (1)

No. Pnt.	Outline points coord.		Lengths sides L(i,i+1)
	X [m]	Y [m]	
1	323264.838	594573.089	31.200
2	323273.024	594603.196	101.929
3	323177.765	594566.931	36.770
4	323185.293	594530.940	57.848
5	323237.935	594554.922	5.514
6	323235.504	594560.203	32.039

A(1)=2938.10sq.m P=265.599m

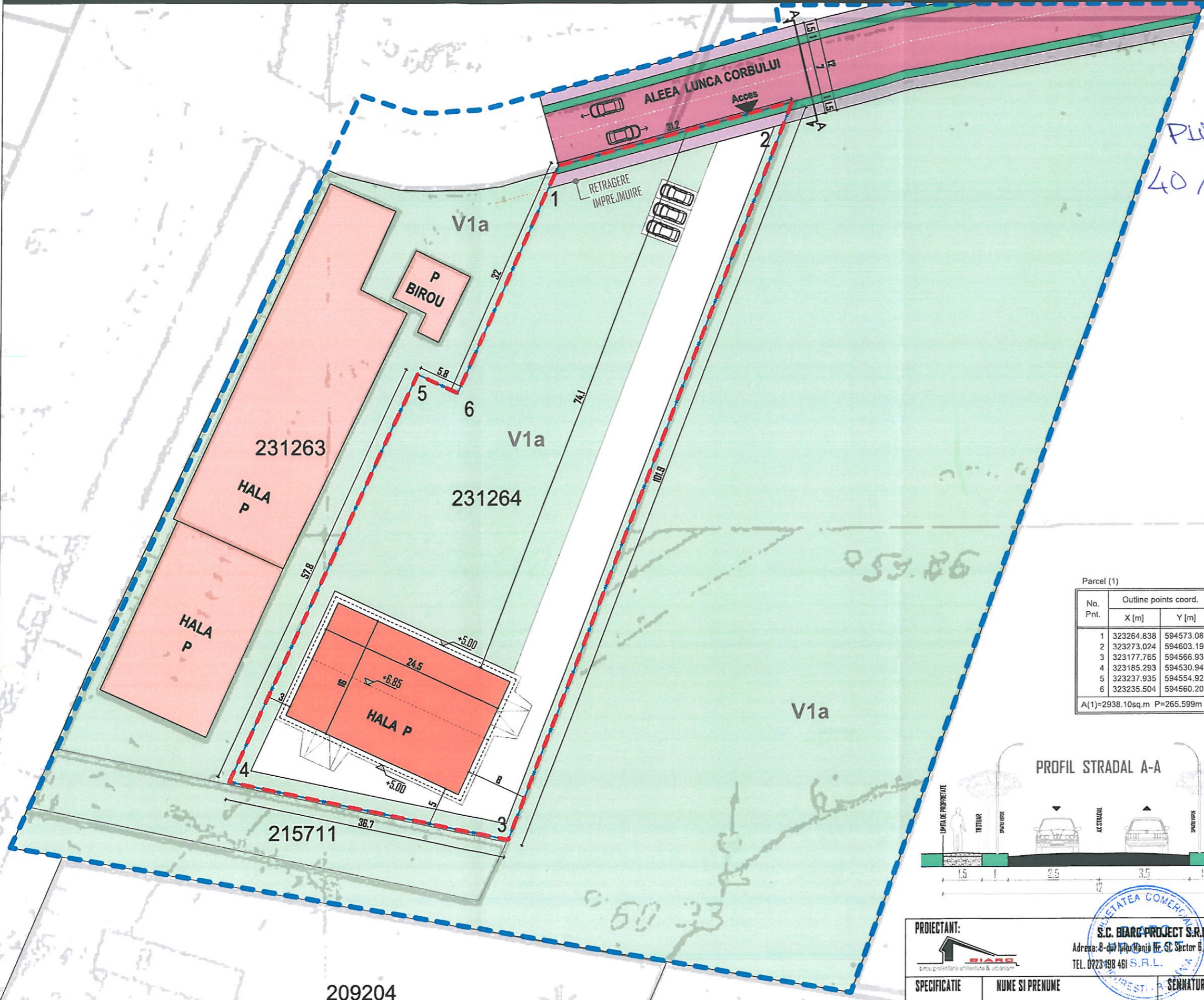
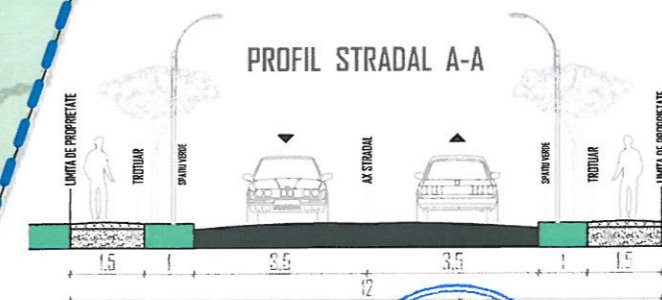

PLD  
40/2018

<b>PROIECTANT:</b> S.C. BIARE PROJECT S.R.L. Adresa: 8-dp Ighitea, Nr. 51, Sector 6, Bucuresti TEL. 0723-198 461 S.R.L.		<b>BENEFICIAR:</b> BANEA CONSTANTIN SI BANEA MARIA		PROIECT NR. 24/5/18	
<b>VERIFICAT:</b> ARH. ROSCAN CATALIN	<b>PROIECTAT:</b> ARH. ROSCAN CATALIN	<b>DESENAT:</b> ARH. ROSCAN CATALIN	<b>SCARA:</b> 1:500	<b>TITLU PROIECT:</b> Realizare constructie pentru administrare si intretinere tip pavilion metalic - parter inalt ADRESA : str. Aleea Lunca Corbului, nr. 2, Sector 3, Bucuresti	FAZA PUD
			<b>DATA:</b> 05.2018	<b>TITLU PLANSA:</b> PROPOUNERI SI REGLEMTARI	PLANSA NR. A 05

31.05.2018